

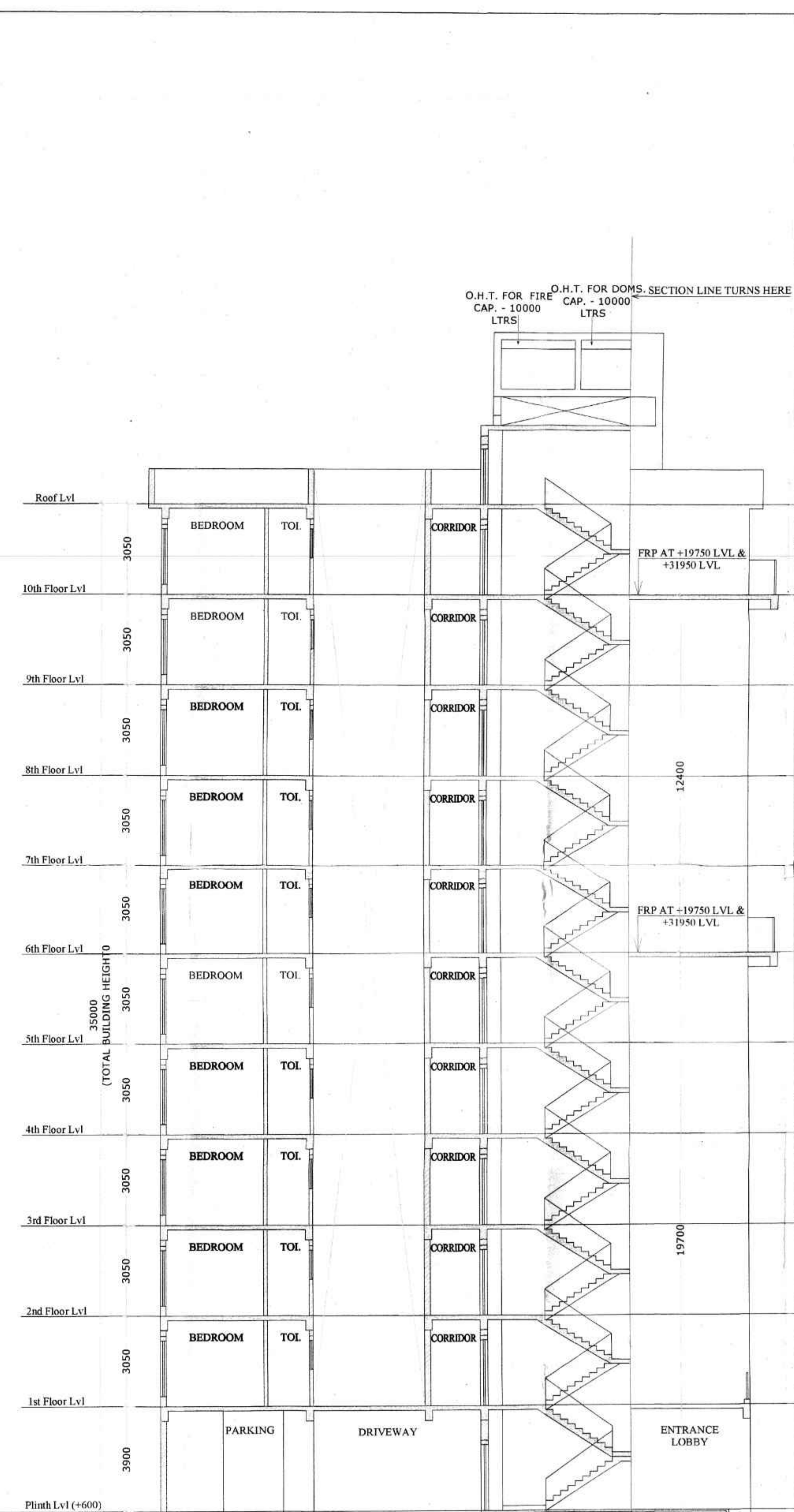

NORTH SIDE ELEVATION
SCALE 1:100



SECTION Y5-Y5
SCALE 1:100

PROJECT: REVISED PLAN SHOWING
ADDITION & ALTERATION OF 6 NOS GROUND + 10
STORIED RESIDENTIAL BUILDING AND ONE NO 3
STORIED AMENITY BLOCK

OWNER: 1.MEGASUN MERCHANTS PVT. LTD.
REPRESENTED BY ONE OF ITS DIRECTOR SRI.
KISHAN AGARWAL
2. KAMAL CHAND BOTHRA
3. ANAND AGARWAL
4. SUSHMA AGARWAL
5. UNITED PROPERTIES PVT. LTD.
REPRESENTED BY ITS DIRECTOR VEDAVID
BASAK

LOCATION: SISHABARI , SILIGURI

LAND SCHEDULE :
MOUZA :SISHABARI
J.L. NO. 41
L.R.PLOT NO. :257,260,261,255,256,258,&259
R.S. PLOT NO. :118,115,116,117,119,120,121
SHEET NO. :01 (L.R) , 01 (R.S)
KHATAN NO. 3650,3651,3649,3614,2168 (L.R)
P.S. : PRADHAN NAGAR
DIST. DARJEELING
Latitude : 26°46'45.00"(N)
Longitude : 88°25'30.33" (E)

NOTE:
ALL DIMENSION ARE IN MM. OTHERWISE MENTIONED.

DECLARATION OF OWNER'S:-
I DO HEREBY DECLARE THAT THE BUILDING PROPOSED FOR
CONSTRUCTION SHALL BE SUPERVISED BY THE B.A./L.B.S.
SIGNING THE BUILDING PLAN APPLICATION OR IN HIS ABSENCE
BY ANY OTHER B.A./L.B.S. OF THE APPROPRIATE CATEGORY
AND AS APPROVED BY THE AUTHORITY.

1) Megasun Merchants Pvt. Ltd.
2) Kamal
3) Anand

Director
Sushma Agarwal United Properties Pvt. Ltd.
N. Vidya Basak Director

SIGNATURE OF OWNER'S

DECLARATION OF STRUCTURAL ENGINEER
THE STRUCTURAL DESIGN AND DRAWING OF BOTH FOUNDATION
AND SUPER STRUCTURE OF THE BUILDING HAS BEEN MADE BY
ME CONSIDERING ALL POSSIBLE LOADS INCLUDING THE SEISMIC
LOAD AS PER THE 'NATIONAL BUILDING CODE' OF INDIA AND
CERTIFIED THAT IT IS SAFE AND STABLE IN ALL RESPECT.
MOREOVER I/WE SHALL BE HELD RESPONSIBLE FOR ANY
STRUCTURE DAMAGE/FAILURE HAPPENED DURING
CONSTRUCTION PERIOD AND THERE AFTER BEYOND DATE OF
TAKING OCCUPANCY CERTIFICATE.

Mangal Majumdar
B.C.E., M.E.C. (Struct)
ESE-1521 of C.O.
STERNKD/100000
074RUP/SCHE/2021-12

SIGNATURE OF STRUCTURAL ENGINEER

DESIGNED AND CHECKED BY ME

SIGNATURE OF GEO-TECHNICAL ENGINEER

DECLARATION OF ARCHITECT / L.B.S.
I DO HEREBY DECLARE THAT THE KEY PLAN, SITE PLAN
AND THE BUILDING PLAN HAVE BEEN PREPARED
UNDER MY SUPERVISION AND I SHALL BE
RESPONSIBLE FOR THE SUPERVISION OF THE
BUILDING.

NAYA BISWAS (B.Arci)
CA/2019/112919

SIGNATURE OF ARCHITECT / L.B.S.

TITLE:- SECTION AND ELEVATION (BLOCK-05)

SCALE:- 1:100
DATE - 18.09.2022
SHEET NO. :- 07
CKD. BY:- K. K. ROY
DRAWN BY:- SHOLANKI

GREEN ARCHITECTURE CONSULTING
ENGINEERS PVT. LTD.

1ST FLOOR,
B.R. AMBEDKAR COMPLEX,
HILL CART ROAD,
SILIGURI - 734003

